

PRODUCT INFORMATION AND APPLICATION STEPS

General information

On a pantile roof you have to apply the MAGE Seal roll with minimum 2 inch (5 cm) overlap.
The tiles and wall surfaces have to be dry and clean and the application temperature should be minimum +42°F (+5°C).

FLASHING APPLICATION

Step 1

- cut the length
- bend off the height of the flashing
- apply on the tile hill



Step 2

- raise up the supernatant on both sides
- remove the protective foil from the upper adhesive strip
- horizontal fixation



Step 3

- additional protection with MAGE Flex final strip
- fastening with plumber screws and dowels

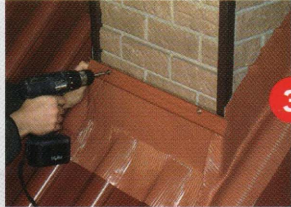

Step 4

- sealing of the upper seam with MAGE sealing compound



MAGE Seal - Plus Set

- for wall flashing



HIP AND RIDGE APPLICATION

Step 1

- place the roll well centred on the roof batten
- fix it with staplers or roofing nails on the ridge batten



Step 2

- bend the roll at the predetermined lines
- press it like a bonnet on the tile surface
- for hip installation, work from the roof ridge to the eaves



Step 3

- please remove the protection foil from the butyl adhesive strip



Step 4

- press the roll step by step on the tile surface
- the corrugation has to be stretched downwards from the top of the tile to the tile valley
- thoroughly press down the edge region



Step 5

- cut the remainders with a knife or plate scissors

